

MONOCRISTALLINE YLF 125 mm SOLAR CELLS 2BB - CONFIDENTIAL

Solar cell structure

产品外观 Product appearance design

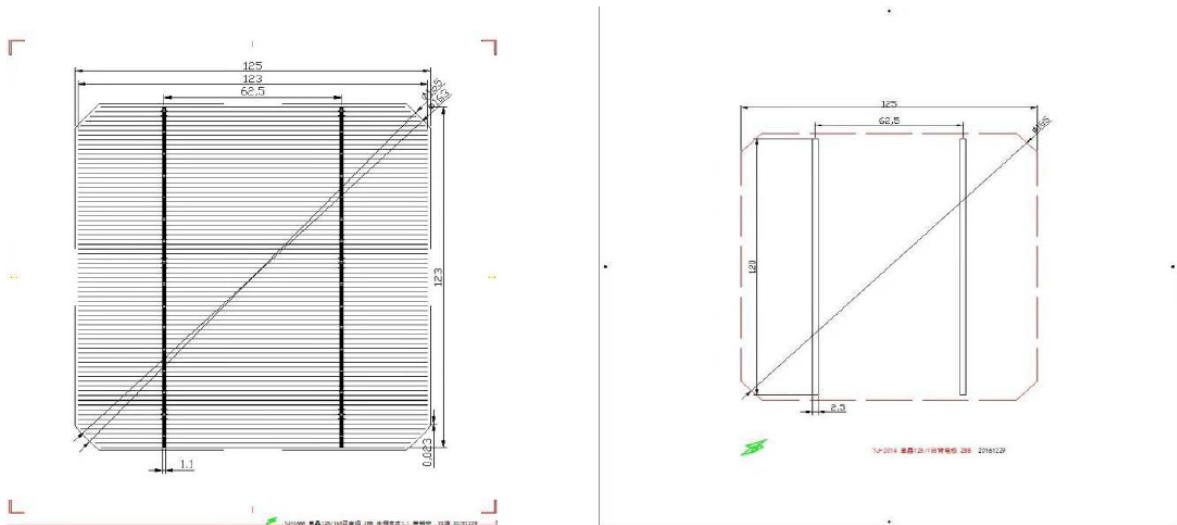

技术数据与设计 Technical data and design

尺寸 Size	125mm*125mm±0.2mm
厚度 (Si) Thickness	150 μ m ± 10 μ m
正面 Front	蓝色氮化硅减反膜, 1.1mm银主栅, 73根银细栅 Blue silicon nitride antireflection film, 1.1mm silver busbars, 73 fingers.
背面 back	AL背场, 2.5mmAg电极 AL back field, 2.5mmAg electrode

IV曲线 IV curve

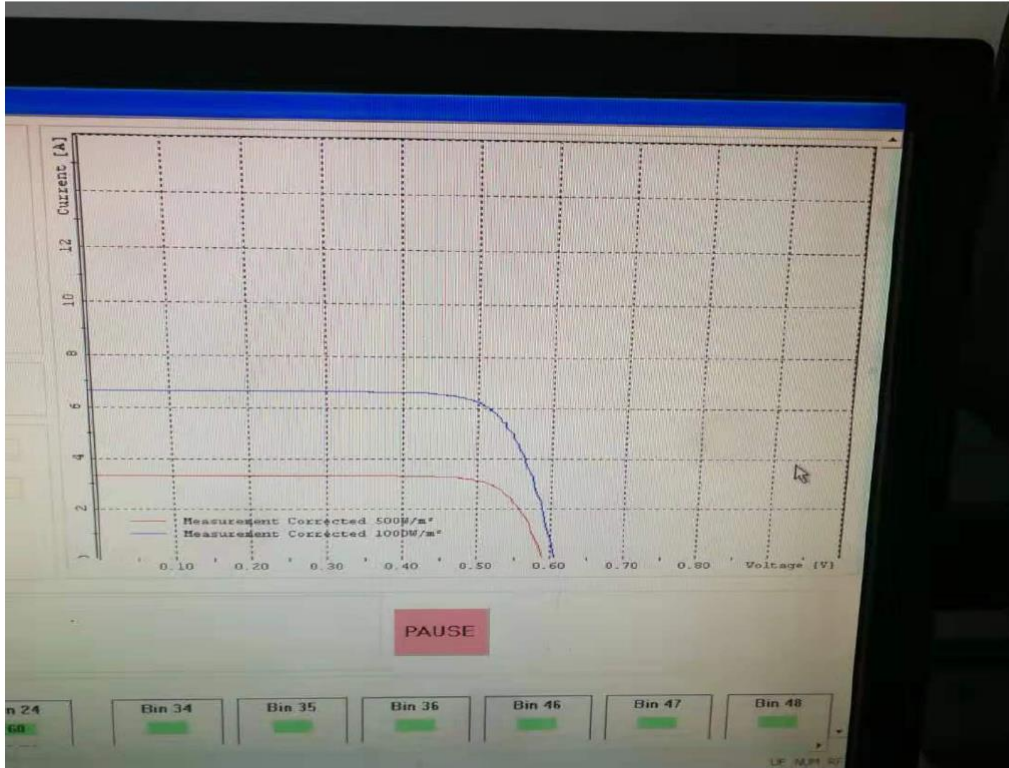

电性能参数 Electrical performance parameters

Eff (%)	20.6	20.4	20.2	20.0	19.8	19.6	19.4	19.2	19.0
Ppm (W)	3.20	3.17	3.14	3.11	3.07	3.03	3.00	2.97	2.94
Ipm (A)	5.860	5.816	5.772	5.738	5.681	5.611	5.576	5.541	5.505
Isc (A)	6.046	6.025	5.995	5.988	5.975	5.965	5.945	5.925	5.905
Vpm (V)	0.546	0.545	0.544	0.542	0.540	0.540	0.538	0.536	0.534
Vov (V)	0.643	0.642	0.640	0.638	0.637	0.637	0.636	0.635	0.634